

Z415 BODY ASSEMBLY WITH "TYPE C" STRAINER

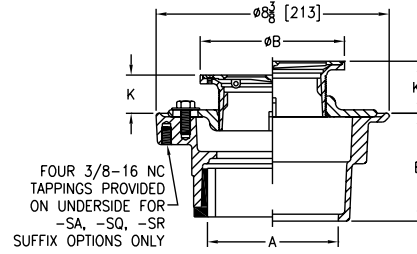

ENGINEERING SPECIFICATION

Zurn ZN415C floor and shower drain features Dura-Coated cast iron body with bottom outlet, combination invertible membrane clamp and adjustable collar with seepage slots, and "TYPE C" polished, hinged nickel bronze, light-duty strainer.



Strainer Designation	Dimensions in inches [mm]						Str. Open Area sq in [cm ²]	Approximate Weight lb [kg]
	A Pipe Size	B Diameter	K		K'			
			Min.	Max.	Min.	Max.		
-5C	2 [51], 3 [76]	5 [127]	1 [25]	1-1/2 [38]	1-3/32 [27]	2-1/4 [57]	8 [52]	11 [5]
-6C	2 [51], 3 [76], 4 [102]	6 [152]		1-25/32 [45]	1-13/32 [36]	2-17/32 [64]	9 [58]	13 [6]
-7C		7 [178]	2-1/8 [54]	1-23/32 [44]	2-7/8 [73]	13 [84]	14 [6]	
-8C	3 [76], 4 [102]	8 [203]		1-5/32 [29]		1-3/4 [44]	16 [7]	18 [8]
	6 [152]		18 [116]					

PREFIXES	DESCRIPTION	STRAINER DESIG.	PIPE SIZE	LIST PRICE
ZN415*	D.C.C.I. Body Assembly with Polished Nickel Bronze Top	-5C	2", 3"	753.00
		-6C	2", 3", 4"	813.00
		-7C	2", 3", 4"	960.00
		-8C	3", 4"	1,054.00
			6"	1,601.00
ZB415	D.C.C.I. Body Assembly with Polished Bronze Top	-5C	2", 3"	719.00
		-6C	2", 3", 4"	753.00
		-7C	2", 3", 4"	923.00
		-8C	3", 4"	983.00
			6"	1,529.00
Z415	D.C.C.I. Body Assembly ONLY (add "-L/Top" to product sku)	No Strainer	2", 3", 4"	194.00
			6"	739.00

OUTLETS (SPECIFY PIPE SIZE IN INCHES AND TYPE OF OUTLET)				
OUTLET TYPE		PIPE SIZE/ OUTLET TYPE	E BODY HT. DIM.	ADD
IC	Inside Caulk	2IC, 3IC, 4IC	4-13/16"	N/C
IP	Threaded	2IP	2-7/16"	80.00
		3IP	2-3/4"	80.00
		4IP	2-13/16"	80.00
		6IP	2-7/8"	80.00
NH	No-Hub	2NH, 3NH, 4NH	3-13/16"	N/C
NL	Neo-Loc	2NL, 3NL, 4NL	3-7/8"	N/C

SUFFIXES		ADD
-AR	Acid Resisting Epoxy Coated Cast Iron	171.00
-CP	Chrome-Plated Bronze Top	26.00
-G	Galvanized Cast Iron	198.00
-P	Trap Primer Connection (1/2")	N/C
Ⓢ -PC	Protective Cover	64.00
Ⓢ -SA	Stabilizer Assembly (See Z1035)	138.00
Ⓢ -SQ	Stabilizer Q-Deck (See Z1035-Q)	184.00
Ⓢ -SR	Stabilizer Ring (See Z400-SR)	121.00
Ⓢ -TC	Neo-Loc Test Cap Gasket (2", 3", 4" NL Bottom Outlet Only)	24.00
-U	1"-3" High Extension Adapter (See Z400-U)	D.C. 140.00
		Galv. 362.00
	For each additional 1" above 3"	98.00
-V	Backwater Valve (Not Available with -Y)	380.00
-VP	Vandal-Proof Secured Top	58.00
-Y	Sediment Bucket (Not Available with -V)	109.00
-90	90° Threaded Side Outlet Body Assembly (2" and 3" Only)	219.00

BEST SELLERS	LIST PRICE
ZN415-2NH-5C	753.00
ZN415-2NL-6C-P-Y	922.00
ZN415-3NL-8C	1,054.00

Supplied By:

877-903-7246
www.commercialplumbingsupply.com

*Regularly furnished unless otherwise specified.

Items designated as Best Sellers are most specified and are generally in stock for shipment.

Ⓢ This symbol denotes a product that is engineered to reduce installation and rework time.

For additional product information, please visit www.zurn.com